

LENGTH OF CRACK	NO. OF STITCHES
<50	1
250 - 500	2
600 - 900	3
950 - 1050	4
1050 - 1350	5
1450 - 1550	6

- NOTES:**
- ALL SURFACES WITHIN 50mm OF CRACK LINE SHALL BE THOROUGHLY CLEANED OF ALL FOREIGN MATERIAL LIKELY TO WEAKEN THE BOND OF THE SURFACE SEALANT.
 - CREATE A 10mm DEPTH IN THE BRICKWORK APPROXIMATELY 50mm WIDE OVER CRACKS.
 - SAW CUT GROOVES PERPENDICULAR TO THE CRACK LINE AND JOINTS. GROOVES SHALL BE 10mm DEEP AND 10mm WIDE. BRICKWORK SURFACES OVER THE CRACK LENGTH SHALL BE V-GROOVES AND PLASTER WITH SPECIFIED MATERIAL USING MESH REF 100.
 - ALL DIMENSIONS TO BE CHECKED ON SITE PRIOR TO THE WORKING. ANY DISCREPANCIES TO BE REPORTED TO THE ENGINEER.
 - DISCREPANCY/ACCURACY IS THE SOLE RESPONSIBILITY OF THE CONTRACTOR.
 - ALL PLASTER CRACKS AND CRACKING OF PLASTER TO BE REPAIRED AS INSTRUCTED BY ENGINEER ON SITE.
 - REPAIRS SHOULD BE USED ON SIMILAR APPROVED PRIMUM CONCRETE REPAIRS. Sika Mono Top 619HB CONCRETE REPAIRS ARTISOL IS.
 - THIS DRAWING AND ALL NOTES MUST BE READ IN CONJUNCTION WITH THE STRUCTURAL ASSESSMENT REPORT.

TYPICAL CRACK STITCHING DETAIL '1'

TYPICAL CRACK STITCHING DETAIL '2'

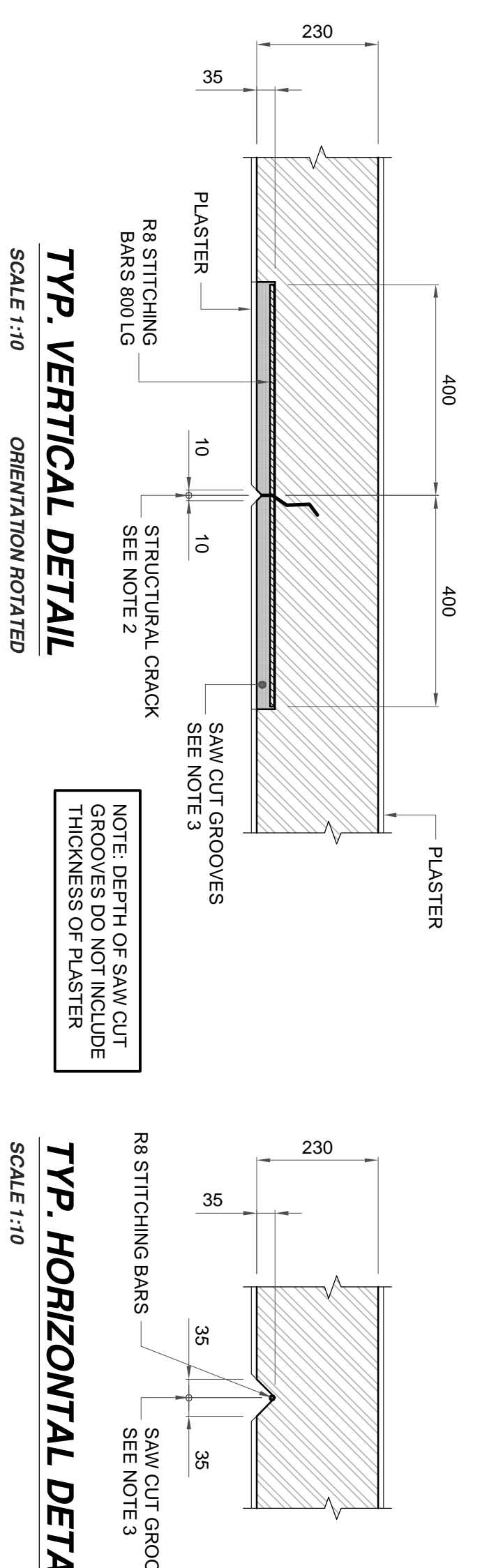
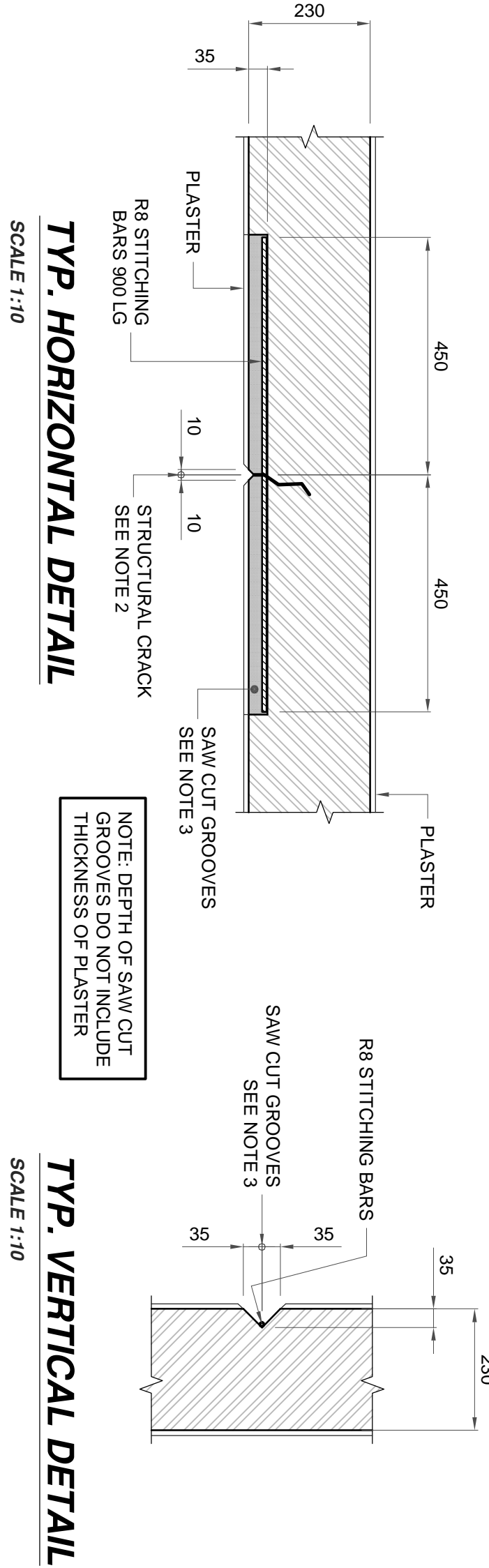

- NOTES:**
- 100mm THICK SURFACE BED
 - 250 MICRON DAMP PROOF
 - MEMBRANE BELOW SURFACE BED
 - THICKENED SURFACE BEDS ON ALL INTERNAL WALLS WITHOUT
 - THICKENED SURFACE BED EDGE
 - FOR RAMPS
 - THICKENED SURFACE BED
 - COMPACTED TO 95% MOD. ASHTO
 - RIP AND RE-COMPACT 150mm INTO
 - MIN. 150mm TO 200mm ASHTO

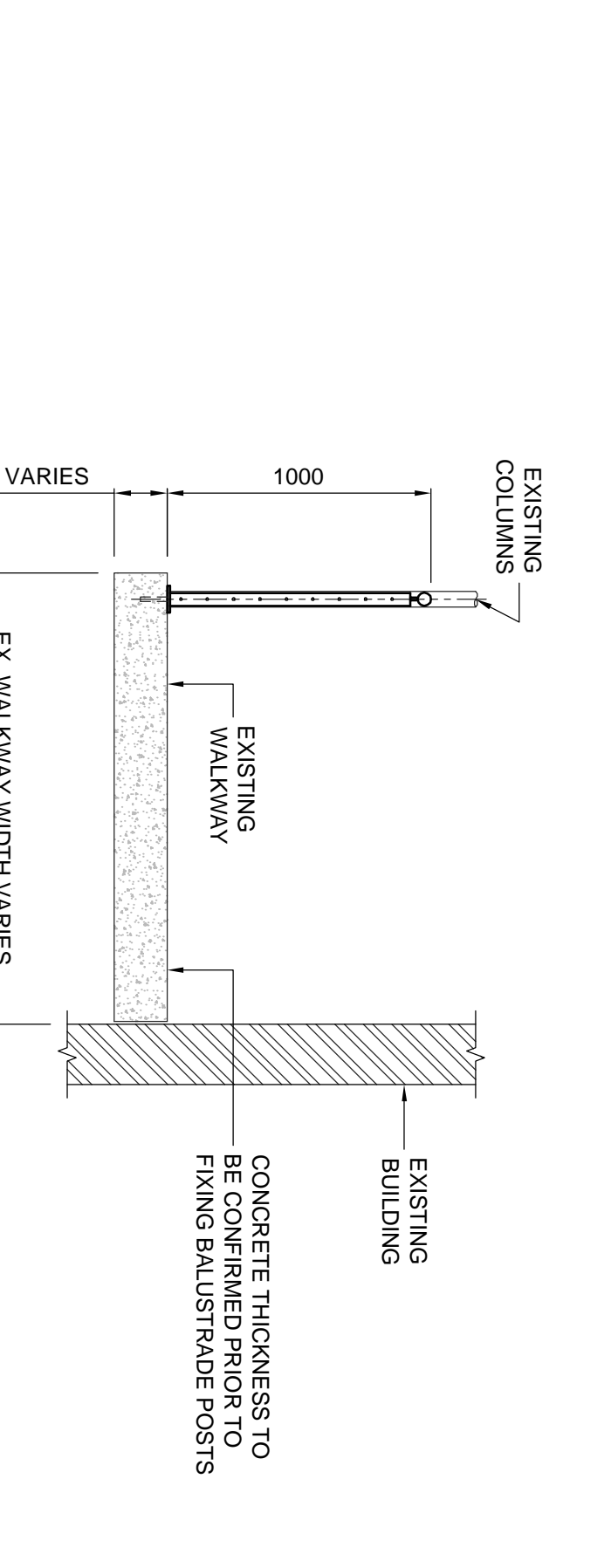
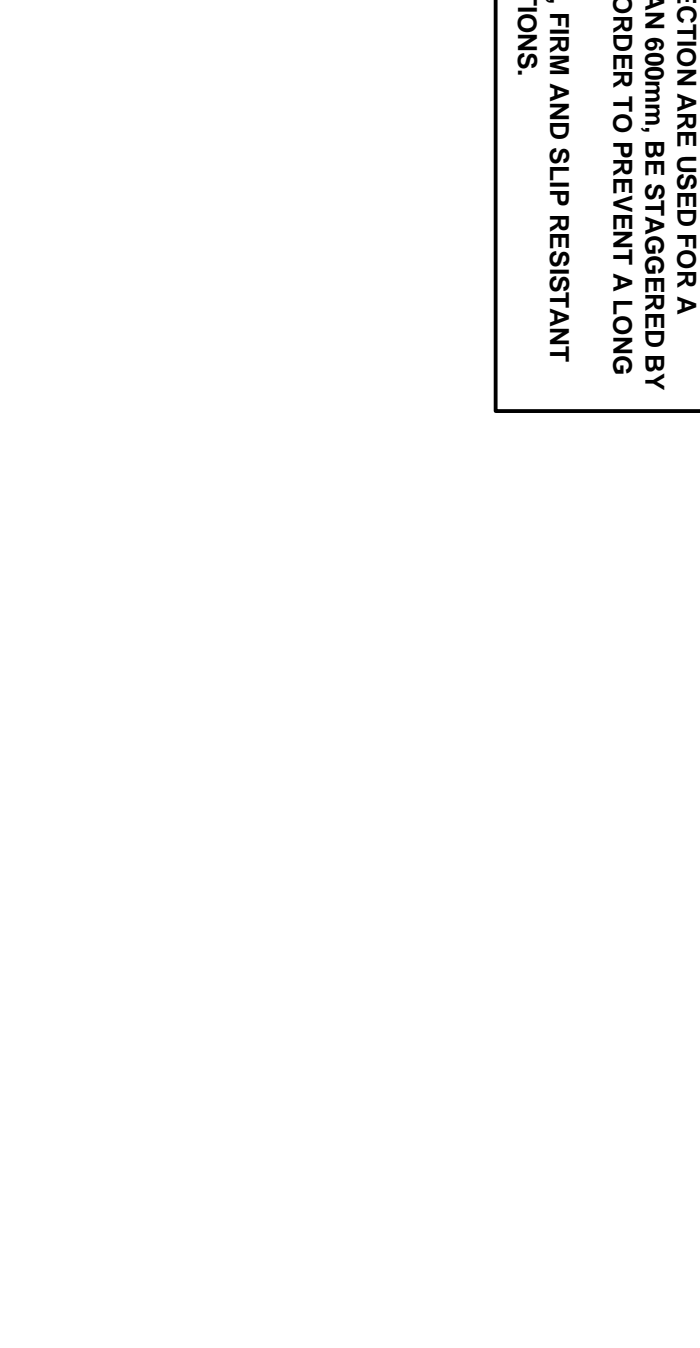
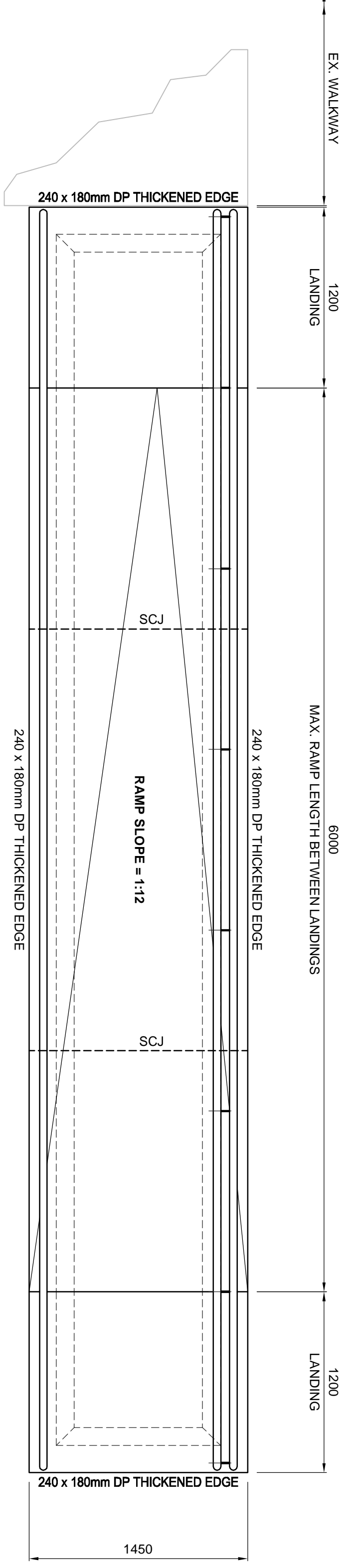
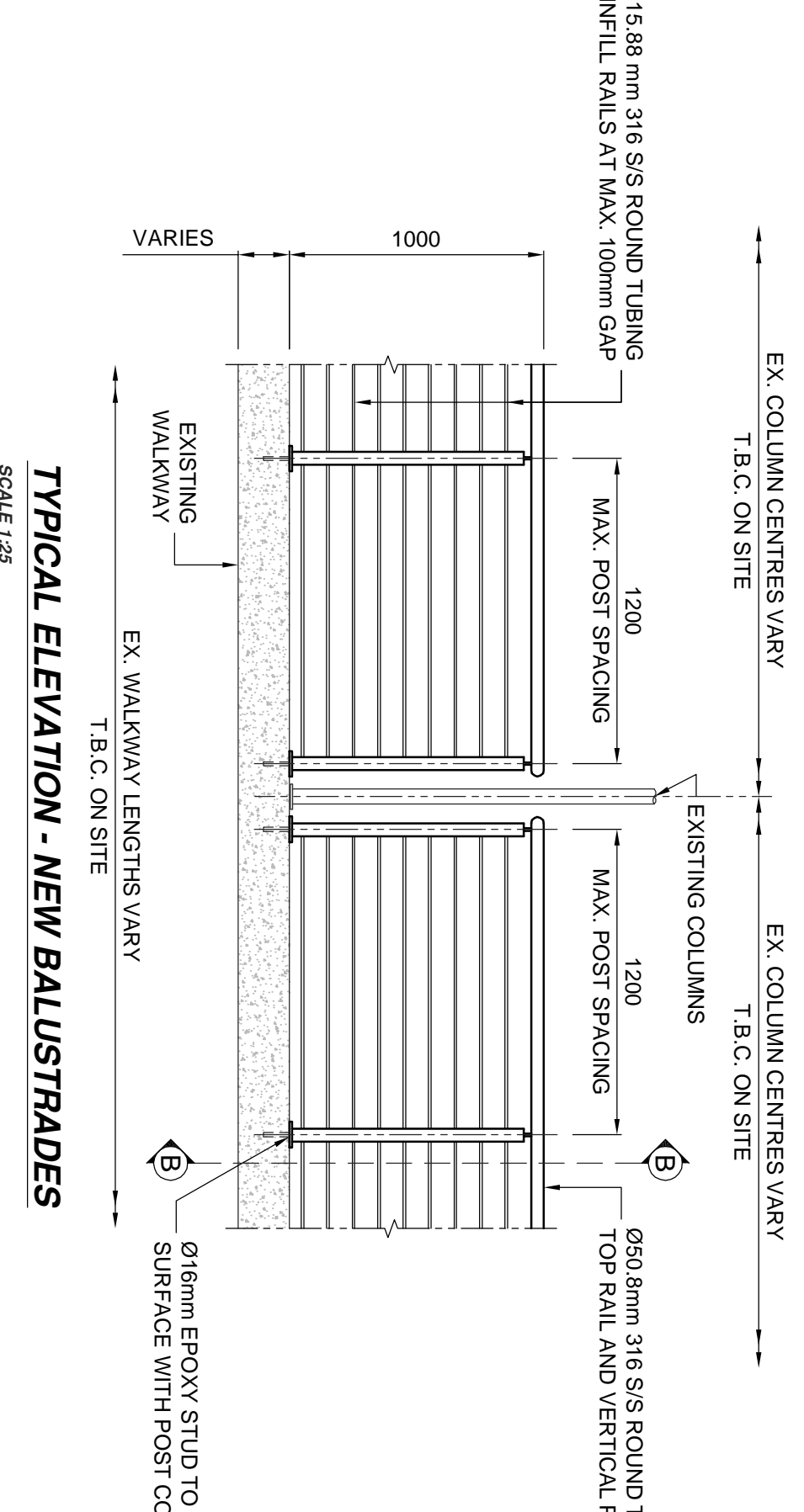
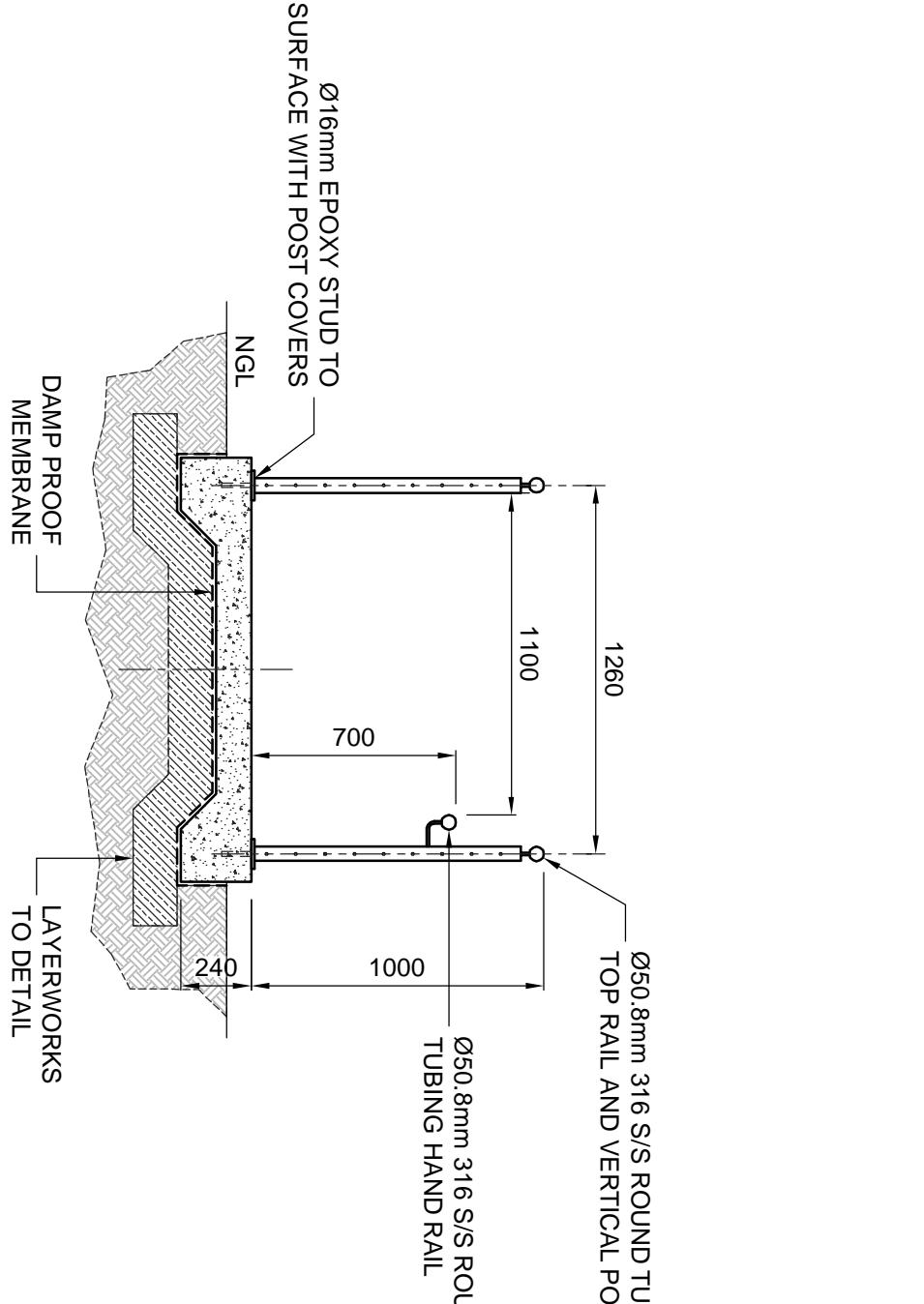
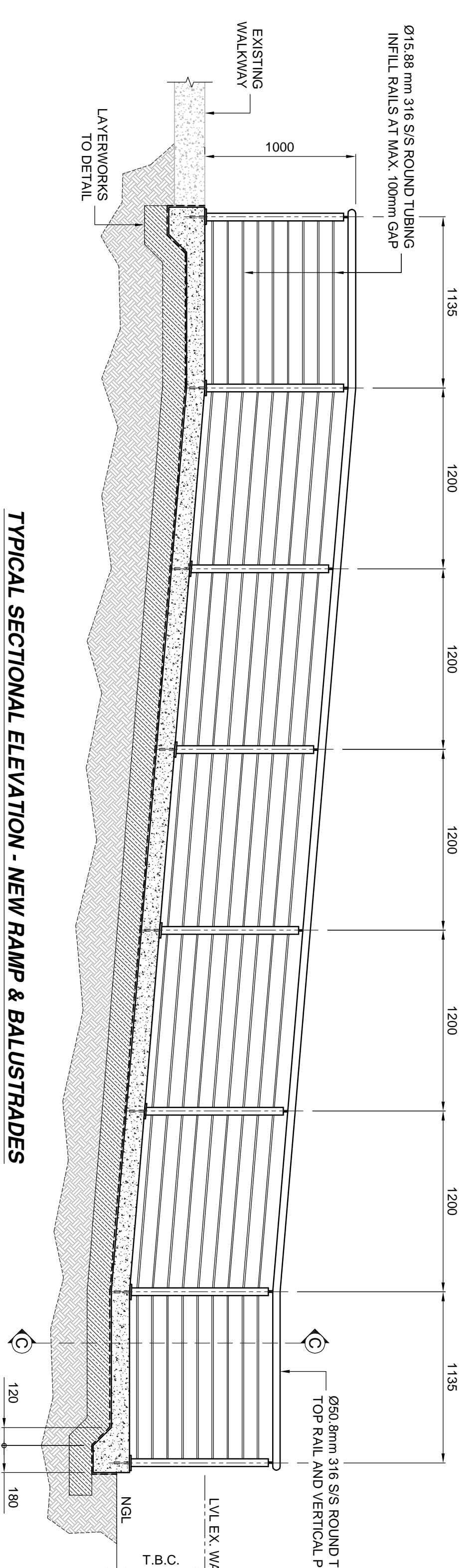
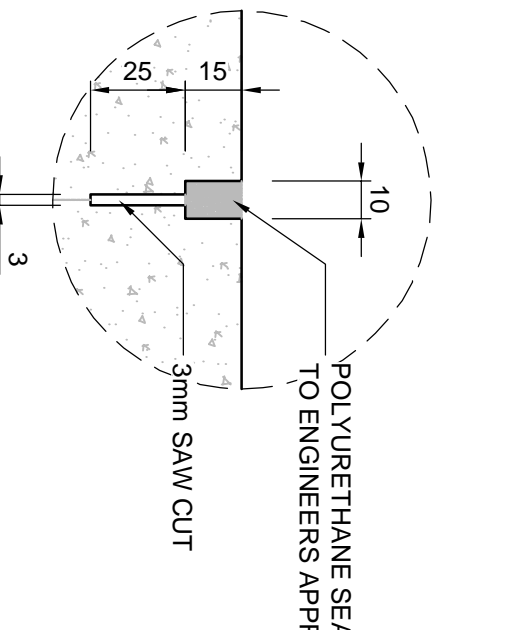
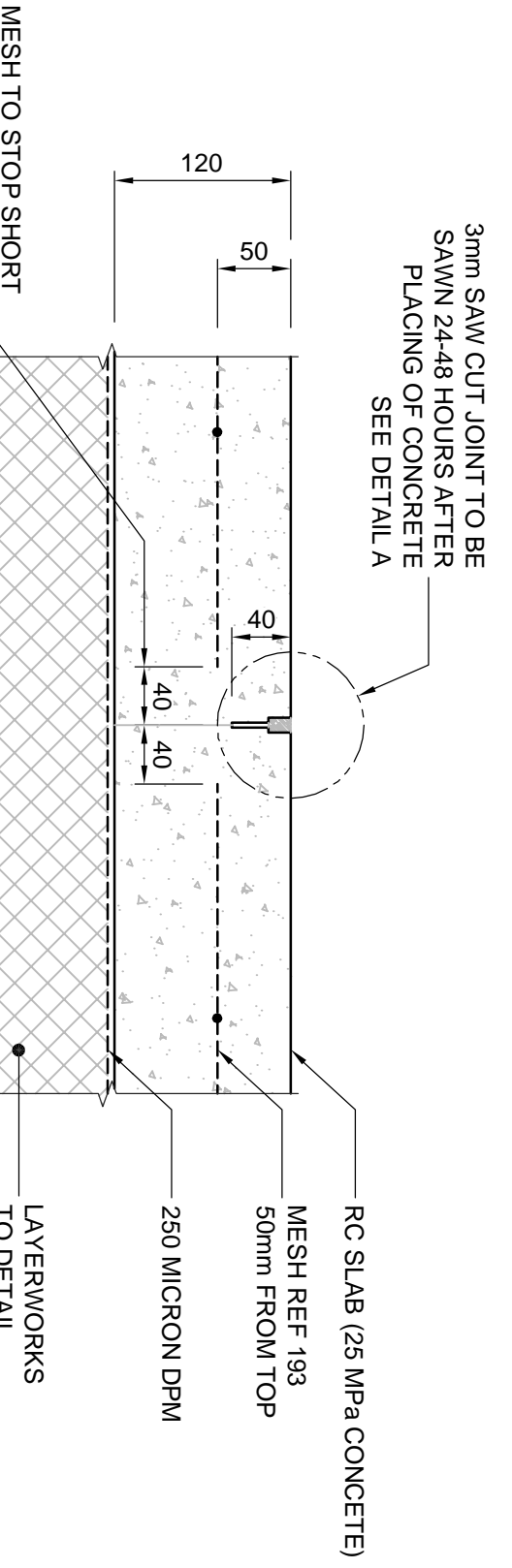

NOTES:

- ALL WORK IN ACCORDANCE WITH THE RELEVANT LOCAL AUTHORITY'S AND STATUTORY BODIES' REQUIREMENTS.
- WHERE REFERENCE IS MADE TO THE SOUTH AFRICAN STANDARDS SPECIFICATIONS, THE CURRENT EDITION SHALL BE USED.
- REFER TO ARCHITECT'S LAYOUTS FOR SETTING OUT INFORMATION.
- ALL DIMENSIONS AND LEVELS TO BE CHECKED ON SITE PRIOR TO CONSTRUCTION. ANY DISCREPANCIES TO BE REPORTED TO THE ENGINEER IMMEDIATELY.
- ONLY WRITTEN DIMENSIONS AND LEVELS SHALL BE USED.
- THIS DRAWING TO BE READ IN CONJUNCTION WITH DRAWINGS FROM THE RELEVANT DISCIPLINES. ARCHITECT, CIVIL, ELECTRICAL AND MECHANICAL.
- THE CONTRACTOR SHALL GIVE THE ENGINEER AT LEAST 24 HOURS ADVANCE NOTICE FOR INSPECTIONS.
- THE ENGINEER SHALL BE NOTIFIED WITHIN 24 HOURS OF ANY DISCREPANCIES BETWEEN DRAWINGS, DETAILS AND SPECIFICATIONS.
- FOUNDATION EXCAVATIONS TO BE INSPECTED AND APPROVED BY THE STRUCTURAL / GEOTECHNICAL ENGINEER BEFORE ANY BLINDING IS CAST.
- REINFORCING TO BE CHECKED AND APPROVED BY THE ENGINEER PRIOR TO CASTING CONCRETE.
- ALL DUCTS OR RECESSES TO BE APPROVED BY THE ENGINEER.
- POSITION OF CONSTRUCTION JOINTS TO BE APPROVED BY THE ENGINEER.
- CONCRETE STRENGTHS @ 28 DAYS:
- FOUNDATIONS : 25 MPa
- COLUMNS : 30 MPa
- ROOF SLABS : 30 MPa
- BEAMS : 30 MPa
- COVER TO STEEL REINFORCEMENT: 100mm
- FOUNDATIONS : 50mm
- BEAMS : 30mm
- COLUMNS : 30mm
- ALL SHARP EXPOSED EDGES TO BE CHAMFERED 20 x 20mm.
- ALL WATERPROOFING TO ARCHITECT'S DETAIL.
- SAW CUTS ARE TO BE MADE AS SOON AS THE CONCRETE IS FIRM ENOUGH NOT TO BE TORN OR DAMAGED BY THE CUTTING BLADE USUALLY BETWEEN 17 TO 20 HRS OF SETTING.
- ALL STEELWORK TO BE FABRICATED AND DELIVERED TO SITE WITH PROTECTIVE COATING (ZINC COATING) BETWEEN 17 TO 20 HRS OF SETTING.
- ALL STEELWORK TO BE 316 STAINLESS STEEL, UNLESS OTHERWISE NOTED.
- A COMPLETE SET OF SHOP DRAWINGS SHALL BE SUBMITTED TO THE ENGINEER FOR APPROVAL BEFORE FABRICATION COMMENCES.
- ALL WELDS TO BE CONTINUOUS FILLET WELDS IN ACCORDANCE WITH SANS AND AWS WELDING STANDARDS.

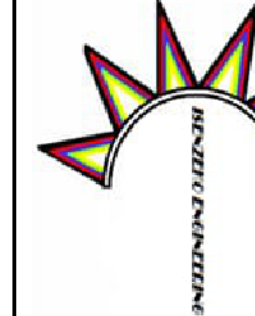

PROJECT
DBSA SCHOOLS FS
HIS WELKOM TECHNICAL HIGH SCHOOL
FREE STATE

DRAWING
TYPICAL DETAILS (SHEET 2)

REVISION	DATE	BY	CHKD	APP'D	SCALE	SHEET NO.	TOTAL SHEETS
1	2023-03-17	LM	KT	MAN OVENBERG (PMD 200847)	AS SHOWN	10	10
2	2023-03-17	LM	KT	MAN OVENBERG (PMD 200847)	AS SHOWN	10	10
3	2023-03-17	LM	KT	MAN OVENBERG (PMD 200847)	AS SHOWN	10	10
4	2023-03-17	LM	KT	MAN OVENBERG (PMD 200847)	AS SHOWN	10	10
5	2023-03-17	LM	KT	MAN OVENBERG (PMD 200847)	AS SHOWN	10	10
6	2023-03-17	LM	KT	MAN OVENBERG (PMD 200847)	AS SHOWN	10	10
7	2023-03-17	LM	KT	MAN OVENBERG (PMD 200847)	AS SHOWN	10	10
8	2023-03-17	LM	KT	MAN OVENBERG (PMD 200847)	AS SHOWN	10	10
9	2023-03-17	LM	KT	MAN OVENBERG (PMD 200847)	AS SHOWN	10	10
10	2023-03-17	LM	KT	MAN OVENBERG (PMD 200847)	AS SHOWN	10	10

DRAWING STATUS CODES:
1 - DESIGN
2 - PRELIMINARY
3 - FOR INFORMATION
4 - FOR APPROVAL
5 - FOR CONSTRUCTION
6 - FOR RECORD
7 - FOR ARCHIVE
8 - FOR DESTRUCTION
9 - FOR REVISION
10 - FOR CANCELLATION